

Serie Steel

BS3000

Cable Chains in Bright Zinc Plated Steel

Inner height (D) 52 mm

Double share link construction.
Single-rievt fixing and standard large washer and nylon anti-friction disk to assure durable smooth movement.
Alu-draw frames (T) or Alu-drilled plates (TL) are un-screwable from both sides.
As standard the frames every second link, on request every link.
Vertical and horizontal separator systems are available.
Also available in Stainless Steel.

Technical characteristics when self-supported

Speed	0,5 m/s
Acceleration	2 m/s ²

For higher requirements please consult our technical dept.

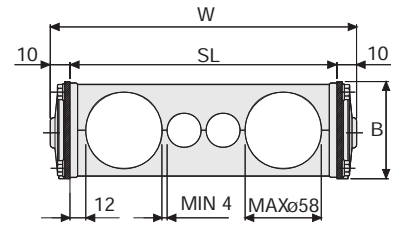
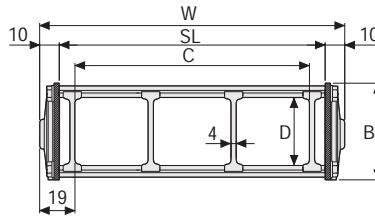

Separator

- Unassembled	Part.no S308CO
- Assembled	Part.no S308COMC

Aluminium Draw Plates with Separators in Nylon

W mm	B mm	C mm	D mm	R mm	Weight/m kg	Chain Part Number
144	74	106	52	150-220-250-305-400-535	7,40	3000NT106□□□*
194	74	156	52	150-220-250-305-400-535	7,60	3000NT156□□□*
244	74	206	52	150-220-250-305-400-535	7,80	3000NT206□□□*
294	74	256	52	150-220-250-305-400-535	8,00	3000NT256□□□*
344	74	306	52	150-220-250-305-400-535	8,20	3000NT306□□□*
C+38	74	52	150-220-250-305-400-535		3000NT □□□□□**

*Complete the code by inserting the value of the radius (R): Ex. 3000NT156 □ □ □ □

**Complete the code by inserting the value of the quote C and the radius (R): Ex. 3000NT □ □ □ □ □ □ □ □ □ □

Chain equipped with aluminium draw plates every pitch: complete the code by inserting the letter D.
Ex. 3000NT156250 □

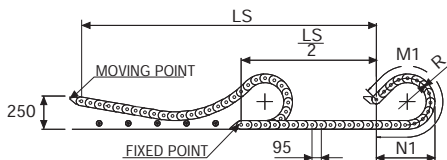
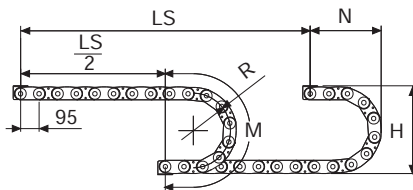

Length of chain (L)

Half travel distance ($\frac{LS}{2}$)

plus length of curve (M)

$$L = \frac{LS}{2} + M \text{ or } M1$$

Aluminium Split Cross Piece Created by Design

W mm	B mm	R mm	Chain Part Number
SL+20	74	150-220-250-305-400-535	3000NTL □ □ □ □ □ □ □ □ □ □ ***

***Complete the code by inserting the value SL and the radius (R): Ex. 3000NTL □ □ □ □ □ □ □ □ □ □

R mm	H* mm	N mm	M mm	N1 mm	M1 mm
150	388	290	670	830	1770
220	528	360	890	1145	2515
250	588	385	980	1255	2800
305	698	440	1150	1450	3285
400	888	540	1450	1740	4065
535	1158	675	1880	2110	5105

* The height H should be increased by 10 mm/m approx. because of preload. In case of limitation to the available space, refer to the Technical Dptm.



Self-Supporting Capacity Diagram

The maximum length of the self-supporting capacity ($\frac{LS}{2}$) in relationship to the weight of the cables and hoses contained per linear metre.

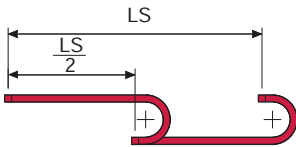
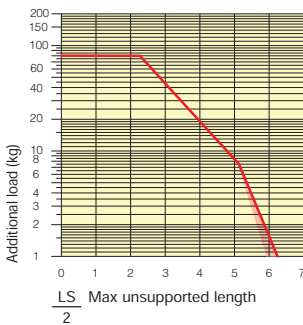

The red marking in the diagram area considers the difference of weight between various widths of chains assembled with aluminium draw plates every second pitch.

For applications with $\frac{LS}{2}$ and weights not included in the area of the diagram showing self-supporting capacity, verify the possible use of support rollers (see page 30).

Bright Zinc Plated Steel End Brackets

The end brackets set, containing four steel plates screwed to the links allows the two ends of the chain to be attached to the equipment.

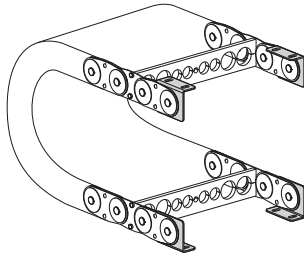
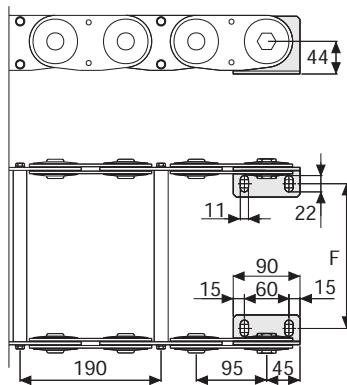

Fig. A
The chain can be fixed frontally, inner or outer radius. (Fig A)



Chain Type	F mm
BS3000NT106	88
BS3000NT156	138
BS3000NT206	188
BS3000NT256	238
BS3000NT306	288
Special dimension F=W-56	

Bright Zinc Plated Steel Type Part Numbers

Complete Set Assembled	
Chain Type	End Brackets Set
BS3000...	A3000NKM

Complete Set Unassembled	
Chain Type	End Brackets Set
BS3000...	A3000NK

Serie Steel

BS3000 Cable Chain in Bright Zinc Plated Steel



Suitable to long travel distance.
See page 190

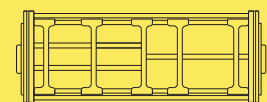

Supplementary movable separators.

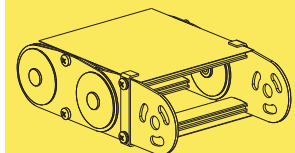

Steel laminar cover.

For further information please consult Brevetti Stendalto's Technical Office

